

MONORACK SPECIFICO - SPECIFIC MONORACK
 MONORACK SPECIFIQUE - SPEZIFISCHES MONORACK - MONORACK ESPECÍFICO

HONDA SHADOW 2004

750cc

ISTRUZIONI DI MONTAGGIO - MOUNTING INSTRUCTIONS
 INSTRUCTIONS DE MONTAGE - BAUANLEITUNG - INSTRUCCIONES DE MONTAJE

1



SUPPORTO
 SUPPORT
 SUPPORT
 HALTERUNG
 SOPORTE

Q.TY n.2(Dx-Sx)

2



VITE TBEI M6x20mm
 SCREW M6x20mm
 VIS M6x20mm
 SCHRAUBE M6x20mm
 TORNILLO M6x20mm

Q.TY n.2

3



VITE TBEI M8x20mm
 SCREW M8x20mm
 VIS M8x20mm
 SCHRAUBE M8x20mm
 TORNILLO M8x20mm

Q.TY n.2

4



RONDELLA IN GOMMA Ø6mm
 RUBBER WASHER
 RONDELLE EN CAOUTCHOUC
 GUMMI SCHEIBE
 ARANDELA DE GOMA

Q.TY n.5

5



RONDELLA Ø6mm Inox
 WASHER Ø6mm
 RONDELLE Ø6mm
 SCHEIBE Ø6mm
 ARANDELA Ø6mm

Q.TY n.5

6



RONDELLA Ø6mm
 WASHER Ø6mm
 RONDELLE Ø6mm
 SCHEIBE Ø6mm
 ARANDELA Ø6mm

Q.TY n.2

7



VITE TCEI M8x20mm
 SCREW M8x20mm
 VIS M8x20mm
 SCHRAUBE M8x20 mm
 TORNILLO M8x20

Q.TY n.2

8



RONDELLA Ø8x14mm
 WASHER Ø8x14mm
 RONDELLE Ø8x14mm
 SCHEIBE Ø8x14mm
 ARANDELA Ø8x14mm

Q.TY n.2

9



DADO M6 INOX CIECO
 BOLT M6
 ECROU M6
 MUTTER M6
 TUERCA CIEGA M6

Q.TY n.5

10



VITE TT M6x20mm
 SCREW M6x20mm
 VIS M6x20mm
 SCHRAUBE M6x20mm
 TORNILLO M6x20mm

Q.TY n.1

11



MODANATURA
 CHROMED DECORATION
 LISTEL CHROME
 CHROMHALTER
 EMBELLECEDOR CROMADO

Q.TY n.1

12

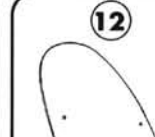

Q.TY n.-

13



RONDELLA Ø6x18Inox
 WASHER Ø6mm
 RONDELLE Ø6mm
 SCHEIBE Ø6mm
 ARANDELA Ø6mm

Q.TY n.1

14



MOUSSE DI GOMMA
 FOAM RUBBER
 MOUSSE EN GOMME
 MOOSGUMMI
 ESPONIA EN GOMA

Q.TY n.1

15



VITE TT M6x25mm
 SCREW M6x25mm
 VIS M6x25mm
 SCHRAUBE M6x25mm
 TORNILLO M6x25mm

Q.TY n.4

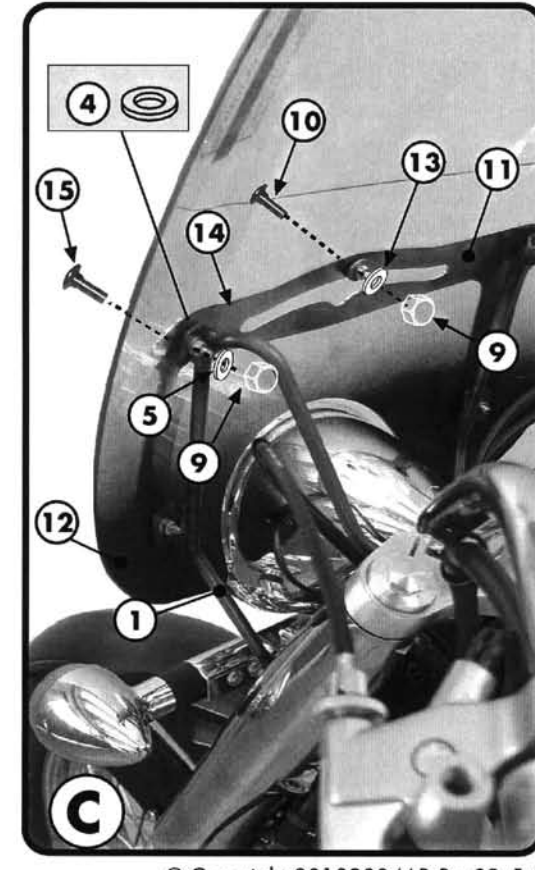
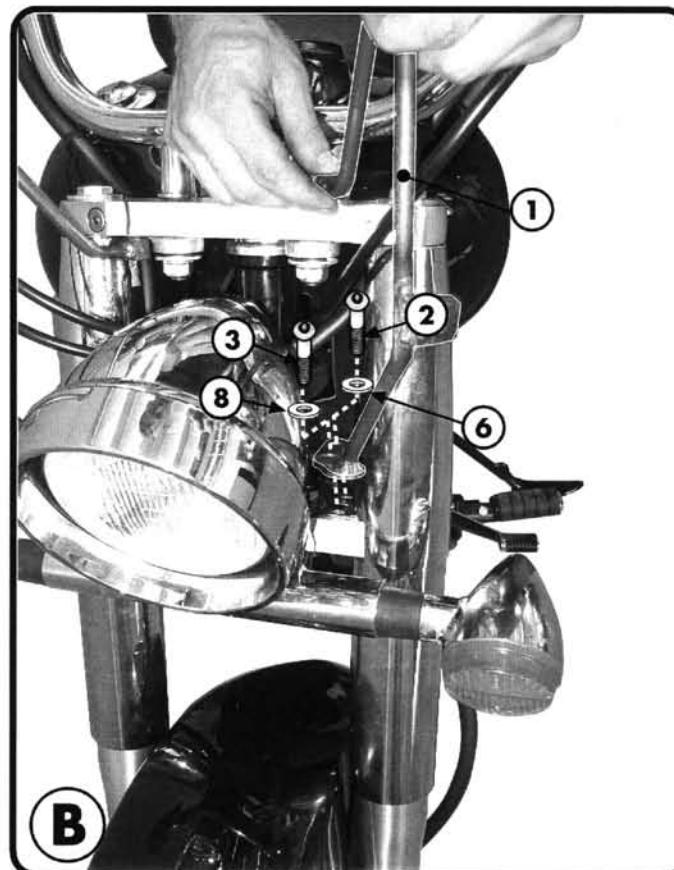
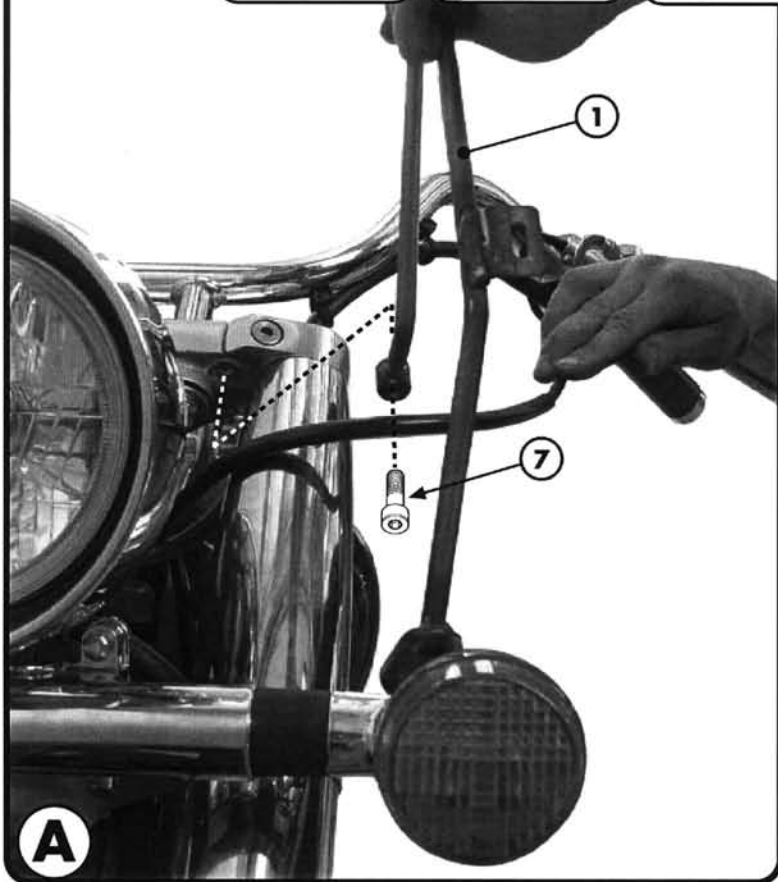

MONORACK SPECIFICO - SPECIFIC MONORACK
MONORACK SPECIFIQUE - SPEZIFISCHES MONORACK - MONORACK ESPECÍFICO

HONDA SHADOW 2004

750cc

ISTRUZIONI DI MONTAGGIO - MOUNTING INSTRUCTIONS
INSTRUCTIONS DE MONTAGE - BAUANLEITUNG - INSTRUCCIONES DE MONTAJE

I ISTRUZIONI DI MONTAGGIO

1. POSIZIONARE I SUPPORTI ED AVVITARE LA VITE COME RAFFIGURATO IN FIGURA A.
2. FISSARE I SUPPORTI COME INDICATO IN FIGURA B.
3. FISSARE IL PARABREZZA AI SUPPORTI COME RAFFIGURATO NELLA FIGURA C.
FARE ATTENZIONE A METTERE LE RONDELLE IN GOMMA TRA I DADI E IL PLEXIGLASS.

GB MOUNTING INSTRUCTIONS

1. PLACE THE SUPPORTS AND TIGHTEN THE SCREW AS SHOWN IN PICTURE A;
2. FIX THE SUPPORTS AS SHOWN IN PICTURE B;
3. FIX THE WINDSCREEN TO THE SUPPORT AS SHOWN IN PICTURE C; PAY ATTENTION THAT THE RUBBER WASHERS ARE INSERTED BETWEEN THE BOLTS AND THE SCREEN.

F INSTRUCTIONS DE MONTAGE

1. POSITIONNER LES SUPPORTS ET VISSER LA VIS COMME ILLUSTRÉ SUR LA PHOTO A;
2. FIXER LES SUPPORTS COMME INDIQUE SUR LA PHOTO B;
3. FIXER LE PARE BRISÉ AUX SUPPORTS COMME MONTRE SUR LA PHOTO C, FAIRE ATTENTION A BIEN METTRE LES RONDELLES EN CAOUTCHOUC DANS LES TROUS DU PLEXIGLASS.

D BAUANLEITUNG

1. POSITIONIEREN SIE DIE HALTERUNGEN UND ZIEHEN SIE DIE SCHRAUBE WIE IM BILD A BESCHRIEBEN FEST;
2. BEFESTIGEN SIE DIE HALTERUNGEN WIE IM BILD B BESCHRIEBEN.
3. BEFESTIGEN SIE DEN WINDSCHILD WIE IM BILD C BESCHRIEBEN. ACHTEN SIE DARAUF, DASS DIE GUMMISCHLEIBEN ZWISCHEN DIE MUTTER UND DEN PLEXIGLAS POSITIONIERT WERDEN.

ES

INSTRUCCIONES DE MONTAJE

1. MONTAR LOS SOPORTES Y ATORNILLAR EL TORNILLO Nº 7 COMO INDICA LA FOTO A;
 2. ANCLAR LOS SOPORTES COMO INDICA LA FOTO B;
 3. ANCLAR LA PANTALLA A LOS SOPORTES COMO INDICA LA FOTO C;
- ¡ATENCIÓN! PONER LAS ARANDELAS DE GOMA Nº 4 ENTRE LAS TUERCAS Y EL PLEXIGLÁS